

USER MANUAL

Welcome to use our portable refrigerator. Please read this manual carefully before using your unit.

Item	Page
Features	2
Safety instructions	2
The function and operation setting	2-3
FAQ	4
Food storage	5
Defrosting	5
Care and cleaning	6
Following situations are normal	6
Technical Specification	6
Disposal	7
Packing List	7

1. Features:

- High efficiency DC inverter compressor and conversion module with high reliability and long life.
- Fluoride-free insulation with good heat preservation performance and low energy consumption.
- 12/24VDC and 110~240VAC power supply, allow use in the car or at home.
- Compressor delay protection
- Quick cooling to -20℃ (based on 25℃ ambient temperature).
- Intelligent car battery protection system.
- Dual door opening direction.
- Wide range electronic temperature control.

2. Safety instructions

—Warning: Do not attempt or continue to operate your unit if it is wet. The installation of the DC power source in the boat should be handled by the qualified personnel.

—Make sure the voltage is within the correct range for socket and cable being used.

The technical data label on the side of the unit shows the voltage ranges.

—No electrical devices inside the refrigerator as they may be damaged.

—During transportation, slope less than 45° and handle carefully.

—Your unit requires good ventilation, allow the following free space for the air circulation:

Back: 200mm

Side: 100mm

—The unit must be placed in dry and ventilated place which is far from heat source (such as stove, flue) and avoid direct sun-shine.

—It is recommended to operate the unit on a flat surface. Maximum operation angle is 30°.

—One piece inner tank allows water filled, but no allows pouring out water by invert the unit. Keep the shells of the unit drying after rained. Not allow dump the unit in the water.

—Although the units has been cleaned before leaving factory, we strongly recommend to use soft cloth dampened with warm water and a little neutral detergent to clean it again, after that wipe it with dry soft cloth. (Warning: Electrical parts can be wiped by dry cloth only)

—Warning: Do not allow children to play games with the refrigerator such as climbing or standing in the refrigerator. They could damage the refrigerator and seriously injure themselves.

3. The function and operation setting.

3.1 Power supply: 12/24V DC or 110~240V AC (enclose adapter) .

3.2 Power cable connection:

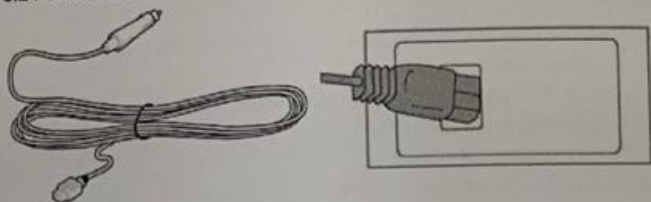

3.3 Operation setting:

—ON/OFF: Connect to the power; press the ON/OFF button for 3 seconds to start the unit. Press the ON/OFF button for 3 seconds again, the unit is turn off.

—Press the button Δ UP or ∇ DOWN button to adjust target temperature. Press the button Δ to increase or the button ∇ to decrease the temperature.

—“SET” BUTTON: Press the button “SET” to enter the economy running mode:

1. ECO (Energy-saving mode)
2. HH (Quick cooling mode)

—Indicator light:

1. Power indicator light in red: the compressor is stopped.
2. Power indicator light in Green: the compressor is working.
3. Eco/Max indicator light in red: quick cooling mode is working.
4. Eco/Max indicator light in green: Energy-saving cooling mode is working.

—Battery Protection: Selecting the H1, H2, H3 positions, you can choose different levels for battery protection. When the unit is on working, press the “SET” button for 3S, then the LED will display as below:

H1: Low power protection.

H2: Middle power

H3: High power protection (factory default)

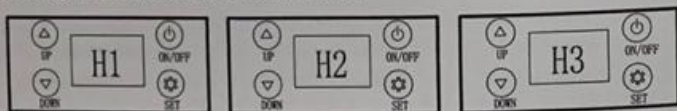

When the unit is connect to the car, we suggest you setting the battery protection to H3 (H) level. H2 (M) and H1 (L) are suggested when the unit is connect to the backup battery. Different car may have different power output voltage. If the voltage protection display (F1 display in the LED), then setting the battery portection from H3 to H2 or H1.

Most car will stop power supply if engine is stopped. But some car will continue power supply even engine is stopped. If your refrigerator is still working when the engine of the car is stopped, then you should adjust the battery protection to H3 (H), otherwise, the power of your car battery may run out and your car battery may not have enough power to start car.

3. 4 Adjust the door opening:

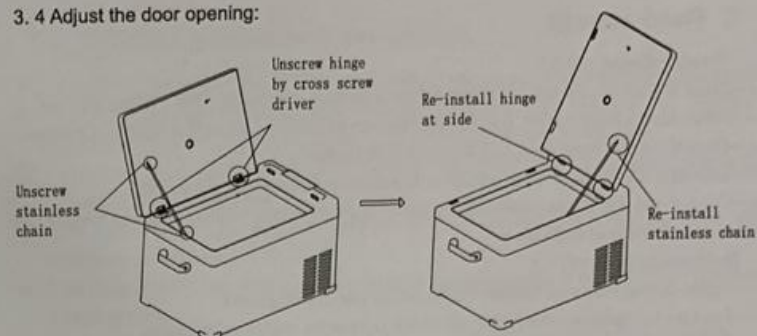

- a. Take down the stainless chain by cross screwdriver
- b. Take down the two hinges
- c. Install the two hinges on the other size between the door and the tank.
- d. Install the stainless chain on the other size between the door and the tank.

4. FAQ

- The appliance is out of working:
 - Check the power supply connection
 - Whether the plug and the socket have a good connection.
 - Whether the fuse has been burned out.
 - Whether the appliance has been turned on
 - Whether the compressor is in delay start protection when the appliance is starting up.
- The food inside is frozen:
 - The setting temperature is too low.
- Hear the sound of water from the inside place.
 - It is normal, due to the flow of refrigerant.
- Display F1 code
 - Low power protection, setting the protection from H3 (H) to H2 (M) or H1 (L)
- Display F2 code
 - Fan overload protection, turn off the unit and restart the unit after 30 minutes. If the F2 is still displayed, please contact the after-sales person.
- Display F3 code
 - The compressor protection is activated. Please turn off the unit and restart the unit after 30 minutes. If the F3 is still displayed, please contact the after-sales person.
- Display F5 code
 - Compressor controller module protection is activated. Please turn off the unit, keep it at ventilated place and restart the unit after 30 minutes. If the F5 code is still displayed, please contact the after-sales person.
- Display F7/F8 code
 - Temperature sensor error. Please restart the unit. If the F7/F8 code is still displayed, please contact the after-sales person.

3. The function and operation setting.

3.1 Power supply: 12/24V DC or 110~240V AC (enclose adapter) .

3.2 Power cable connection:

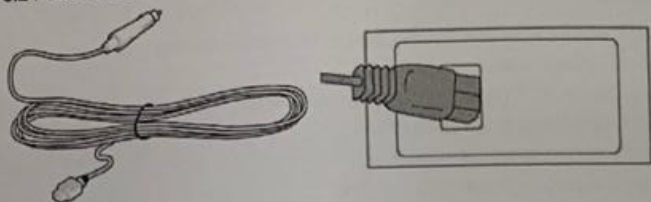

3.3 Operation setting:

—ON/OFF: Connect to the power; press the ON/OFF button for 3 seconds to start the unit. Press the ON/OFF button for 3 seconds again, the unit is turn off.

—Press the button Δ UP or ∇ DOWN button to adjust target temperature. Press the button Δ to increase or the button ∇ to decrease the temperature.

—“SET” BUTTON: Press the button “SET” to enter the economy running mode:

1. ECO (Energy-saving mode)
2. HH (Quick cooling mode)

—Indicator light:

1. Power indicator light in red: the compressor is stopped.
2. Power indicator light in Green: the compressor is working.
3. Eco/Max indicator light in red: quick cooling mode is working.
4. Eco/Max indicator light in green: Energy-saving cooling mode is working.

—Battery Protection: Selecting the H1, H2, H3 positions, you can choose different levels for battery protection. When the unit is on working, press the “SET” button for 3S, then the LED will display as below:

H1: Low power protection.

H2: Middle power

H3: High power protection (factory default)

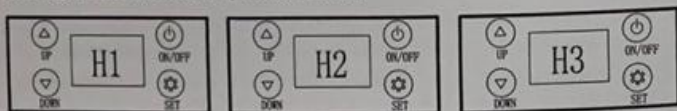

When the unit is connect to the car, we suggest you setting the battery protection to H3 (H) level. H2 (M) and H1 (L) are suggested when the unit is connect to the backup battery. Different car may have different power output voltage. If the voltage protection display (F1 display in the LED), then setting the battery portection from H3 to H2 or H1.

Most car will stop power supply if engine is stopped. But some car will continue power supply even engine is stopped. If your refrigerator is still working when the engine of the car is stopped, then you should adjust the battery protection to H3 (H), otherwise, the power of your car battery may run out and your car battery may not have enough power to start car.

3. 4 Adjust the door opening:

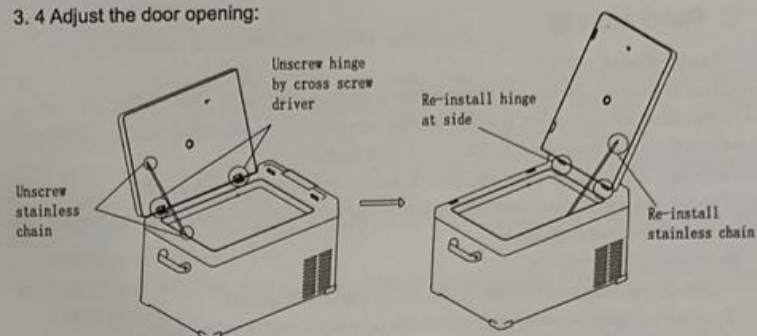

- a. Take down the stainless chain by cross screwdriver
- b. Take down the two hinges
- c. Install the two hinges on the other size between the door and the tank.
- d. Install the stainless chain on the other size between the door and the tank.

4. FAQ

- The appliance is out of working:
 - Check the power supply connection
 - Whether the plug and the socket have a good connection.
 - Whether the fuse has been burned out.
 - Whether the appliance has been turned on
 - Whether the compressor is in delay start protection when the appliance is starting up.
- The food inside is frozen:
 - The setting temperature is too low.
- Hear the sound of water from the inside place.
 - It is normal, due to the flow of refrigerant.
- Display F1 code
 - Low power protection, setting the protection from H3 (H) to H2 (M) or H1 (L)
- Display F2 code
 - Fan overload protection, turn off the unit and restart the unit after 30 minutes. If the F2 is still displayed, please contact the after-sales person.
- Display F3 code
 - The compressor protection is activated. Please turn off the unit and restart the unit after 30 minutes. If the F3 is still displayed, please contact the after-sales person.
- Display F5 code
 - Compressor controller module protection is activated. Please turn off the unit, keep it at ventilated place and restart the unit after 30 minutes. If the F5 code is still displayed, please contact the after-sales person.
- Display F7/F8 code
 - Temperature sensor error. Please restart the unit. If the F7/F8 code is still displayed, please contact the after-sales person.